

**TEKTRONIX®**

**P7001  
Main Interface**

**SERVICE**

**INSTRUCTION MANUAL**

Tektronix, Inc.  
P.O. Box 500  
Beaverton, Oregon 97077

Serial Number \_\_\_\_\_

## **WARRANTY**

**All TEKTRONIX instruments are warranted against defective materials and workmanship for one year. Any questions with respect to the warranty should be taken up with your TEKTRONIX Field Engineer or representative.**

**All requests for repairs and replacement parts should be directed to the TEKTRONIX Field Office or representative in your area. This will assure you the fastest possible service. Please include the instrument Type Number or Part Number and Serial Number with all requests for parts or service.**

**Specifications and price change privileges reserved.**

**Copyright © 1974 by Tektronix, Inc., Beaverton, Oregon. Printed in the United States of America. All rights reserved. Contents of this publication may not be reproduced in any form without permission of Tektronix, Inc.**

**U.S.A. and foreign TEKTRONIX products covered by U.S. and foreign patents and/or patents pending.**

**TEKTRONIX is a registered trademark of Tektronix, Inc.**

# P7001 Main Interface

## Table of Contents

DPO INTERCONNECTIONS	1
Fig. 1 - Example Interconnections	1
MAIN INTERFACE BOARD	2
Fig. 2 - Card Connectors	2
Data Channel Grant	2
Interconnections Between P7001 Circuit Cards	3
Power Supply Voltages	3
Cabling Information	4
COLOR CODES	4
ELECTRICAL PARTS LIST	5
DPO DISASSEMBLY/ASSEMBLY INSTRUCTIONS	9
Fig. 3 - Main Interface to APD Interconnect Cabling	
Fig. 4 - Main Interface Coaxial Connections	
Fig. 5 - DPO Disassembly/Assembly	
APD INTERCONNECT BOARD --- Diagram 2	
Fig. 6 - Main Interface Board Component Location	
Fig. 7 - Common Bus Pin Terminations	
MAIN INTERFACE BOARD --- Diagram 3	
MECHANICAL PARTS LIST	8



# P7001 Main Interface

## DPO INTERCONNECTIONS

Diagram #2 and the example in Figure 1 show the interconnections between the A7704 Acquisition Unit, the P7001 Processor, and the D7704 Display Unit. These connections are made by the APD Interconnect board. "APD" is an acronym for the A7704-P7001-D7704 combination. Some lines between the A7704 and the D7704 are broken to allow connection of signals through the P7001 circuits; for example, the horizontal and vertical analog signals and Z-Axis information. Other interconnecting lines are tapped to allow the P7001 Processor to monitor, select, or assert signals as required; for example, the row and column readout information and readout timing signals.

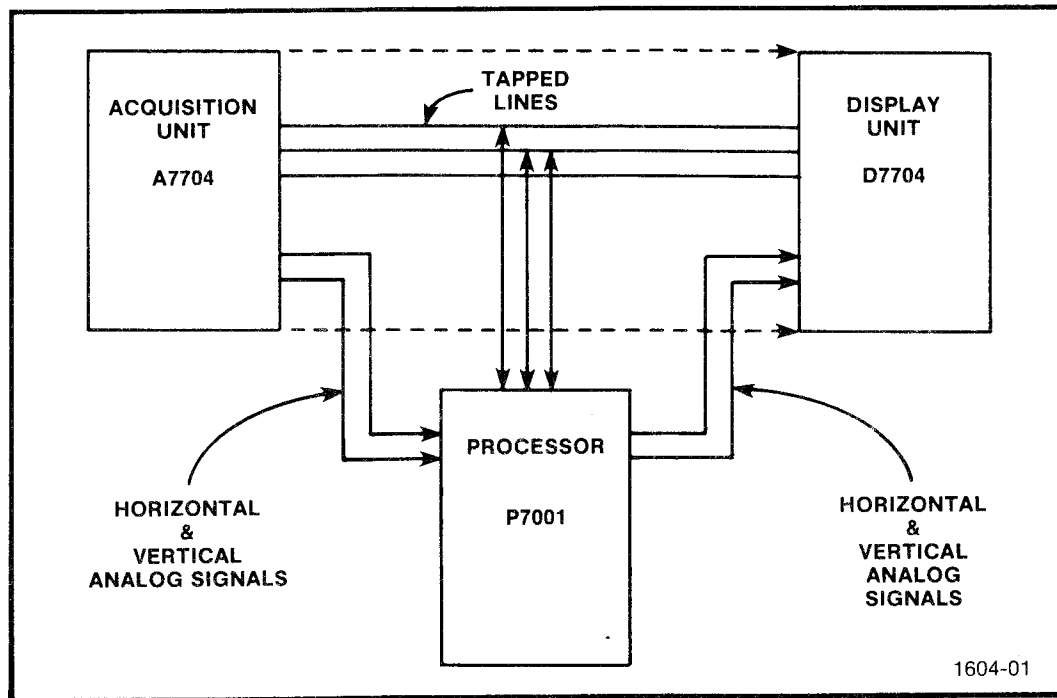

Fig. 1. Example Interconnections.

# P7001 Main Interface

## MAIN INTERFACE BOARD

The P7001 circuit cards plug into connectors located on the Main Interface board. The asynchronous bus lines, control lines, and power lines are all etched on the Main Interface board. There are 11 circuit card connectors on the board with their pin terminations shown in schematic diagram 3. The circuit cards must be plugged into a specific connector, for example (J1=SAMPLE & HOLD, etc.). The cards must not be placed in any order other than that shown on diagram 3. The dedicated pin terminations for each specific circuit card are shown on the connector symbols. The common pin terminations for all connectors are shown in Fig. 7 located on the same page as diagram 3. I/O Interface Connectors, J10 and J11, are shown in diagram 3 as dotted lines. This designates that they are physically located on the rear of the Main Interface board (see Fig. 2).

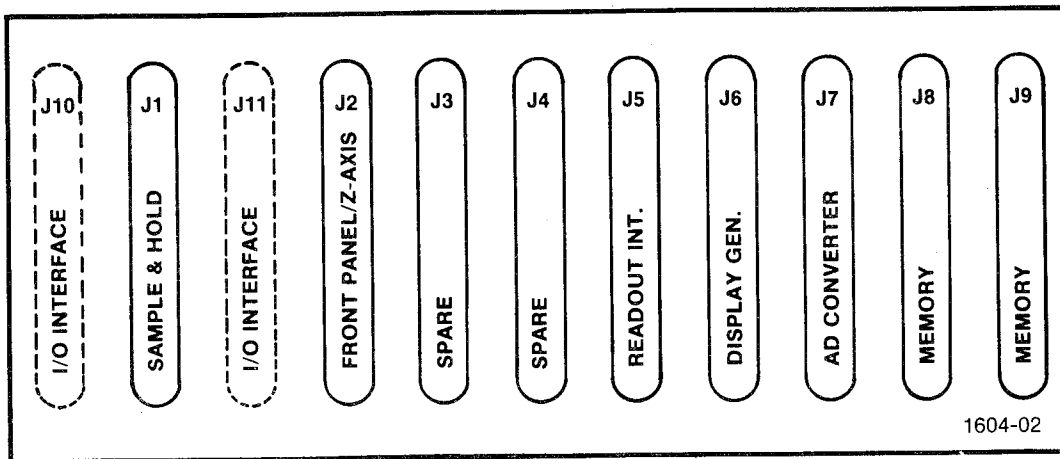

Fig. 2 Card Connectors.

### Data Channel Grant (DATA CH GRANT)

The DATA CH GRANT priority connections are shown running from connector to connector in diagram 3. DATA CH GRANT starts in the Front Panel circuit card (J2) - pin A13 and B13. It then goes to

## P7001 Main Interface

the A-D Converter (J7) - pin B13. It leaves J7 pin A13 and goes to the Display Generator (J6) - pin B13. As can be seen, this process continues through all cards in a "daisy-chain" sequence. Since the DATA CH GRANT signal goes through each card in series, the card it first goes through has the first opportunity to catch DATA CH GRANT in; therefore, it has first priority on the use of the bus.

### Interconnections Between P7001 Circuit Cards

Some interconnections between cards use coaxial lines, such as HORIZ SELECT, etc. These are shown along the top of the row of connectors in diagram 3. These are in addition to the common bus lines. These lines are required because of the type of signal and since they only go to one or two cards. For example, readout row and column information goes only to the Readout Interface Card.

### Power Supply Voltages

Power supply voltages enter in the lower right portion of diagram 3 and terminate on each of the connectors as shown on the common connector symbol Fig. 7. From this point the voltage and ground sensing wires return to the Power Supply. The sensing wires are used to more closely regulate the voltages used in the P7001. Due to the high current in the interconnecting leads between the Power Supply and the Main Interface board, some voltage loss occurs. The sense lines carry very little current; therefore, they provide the power supply regulators a sample of the actual voltage and ground potential at the end of the high current carrying leads.

## P7001 Main Interface

### Cabling Information

Figure 3 shows the cabling necessary to connect the Main Interface board to the APD Interconnect board. It also shows the other connections from the P7001 to the APD Interconnect board. Figure 4 shows the various coaxial cable connections on the Main Interface board, with color codes and signal names.

### COLOR CODES

Color codes of cables and wires used in the figures in this manual conform to the EIA color code standards for resistors. The first number indicates the background color of the wire; the second number indicates the color of the stripe. For example: 9-4 means a white (9) wire with a yellow (4) stripe. 9-n means a solid white wire. 9-0-6 means a white (9) wire with two stripes; a wide black (0) and a narrow blue (6) stripe.



# REPLACEABLE ELECTRICAL PARTS

## PARTS ORDERING INFORMATION

Replacement parts are available from or through your local Tektronix, Inc. Field Office or representative.

Changes to Tektronix instruments are sometimes made to accommodate improved components as they become available, and to give you the benefit of the latest circuit improvements developed in our engineering department. It is therefore important, when ordering parts, to include the following information in your order: Part number, instrument type or number, serial number, and modification number if applicable.

If a part you have ordered has been replaced with a new or improved part, your local Tektronix, Inc. Field Office or representative will contact you concerning any change in part number.

Change information, if any, is located at the rear of this manual.

## SPECIAL NOTES AND SYMBOLS

X000 Part first added at this serial number  
00X Part removed after this serial number

## ITEM NAME

In the Parts List, an Item Name is separated from the description by a colon (:). Because of space limitations, an Item Name may sometimes appear as incomplete. For further Item Name identification, the U.S. Federal Cataloging Handbook H6-1 can be utilized where possible.

## ABBREVIATIONS

ACTR	ACTUATOR	PLSTC	PLASTIC
ASSY	ASSEMBLY	QTZ	QUARTZ
CAP	CAPACITOR	RECP	RECEPTACLE
CER	CERAMIC	RES	RESISTOR
CKT	CIRCUIT	RF	RADIO FREQUENCY
COMP	COMPOSITION	SEL	SELECTED
CONN	CONNECTOR	SEMICOND	SEMICONDUCTOR
ELCTLT	ELECTROLYTIC	SENS	SENSITIVE
ELEC	ELECTRICAL	VAR	VARIABLE
INCAND	INCANDESCENT	WW	WIREWOUND
LED	LIGHT EMITTING DIODE	XFMR	TRANSFORMER
NONWIR	NON WIREWOUND	XTAL	CRYSTAL

Electrical Parts List—P7001 Main Interface

**CROSS INDEX MFR. CODE NUMBER TO MANUFACTURER**

<b>MFR.CODE</b>	<b>MANUFACTURER</b>	<b>ADDRESS</b>	<b>CITY,STATE,ZIP</b>
05397	Union Carbide Corp., Materials Systems Division	11901 Madison Ave.	Cleveland, OH 44101
56289	Sprague Electric Co.		North Adams, MA 01247
80009	Tektronix, Inc.	P. O. Box 500	Beaverton, OR 97077
90201	Mallory Capacitor Co., Div. of P. R. Mallory Co., Inc.	3029 E. Washington St.	Indianapolis, IN 46206

Electrical Parts List—P7001 Main Interface

Ckt No.	Tektronix Part No.	Serial/Model No. Eff Dscont	Name & Description	Mfr Code	Mfr Part Number
	670-2376-00		CKT BOARD ASSY:APD INTERCONNECT	80009	670-2376-00
J213A	131-1003-00		CONNECTOR BODY, :CKT BD MT, 3 PRONG	80009	131-1003-00
J253A	131-1003-00		CONNECTOR BODY, :CKT BD MT, 3 PRONG	80009	131-1003-00
J253B	131-1003-00		CONNECTOR BODY, :CKT BD MT, 3 PRONG	80009	131-1003-00
J255A	131-1003-00		CONNECTOR BODY, :CKT BD MT, 3 PRONG	80009	131-1003-00
J255B	131-1003-00		CONNECTOR BODY, :CKT BD MT, 3 PRONG	80009	131-1003-00
J263B	131-1003-00		CONNECTOR BODY, :CKT BD MT, 3 PRONG	80009	131-1003-00
	670-2378-00		CKT BOARD ASSY:MAIN INTERFACE	80009	670-2378-00
C1	290-0326-00		CAP. ,FXD,ELCTLT:820UF,10%,6V	05397	K820A6KS
C3	290-0326-00		CAP. ,FXD,ELCTLT:820UF,10%,6V	05397	K820A6KS
C5	290-0326-00		CAP. ,FXD,ELCTLT:820UF,10%,6V	05397	K820A6KS
C11	290-0326-00		CAP. ,FXD,ELCTLT:820UF,10%,6V	05397	K820A6KS
C13	290-0326-00		CAP. ,FXD,ELCTLT:820UF,10%,6V	05397	K820A6KS
C15	290-0326-00		CAP. ,FXD,ELCTLT:820UF,10%,6V	05397	K820A6KS
C21	290-0519-00		CAP. ,FXD,ELCTLT:100UF,20%,20V	56289	196D107X0020MA3
C31	290-0716-00		CAP. ,FXD,ELCTLT:8.2UF,20%,75V	05397	T11C825M075AS
C33	290-0716-00		CAP. ,FXD,ELCTLT:8.2UF,20%,75V	05397	T11C825M075AS
C41	290-0519-00		CAP. ,FXD,ELCTLT:100UF,20%,20V	56289	196D107X0020MA3
C43	290-0519-00		CAP. ,FXD,ELCTLT:100UF,20%,20V	56289	196D107X0020MA3
C45	290-0519-00		CAP. ,FXD,ELCTLT:100UF,20%,20V	56289	196D107X0020MA3
C47	290-0519-00		CAP. ,FXD,ELCTLT:100UF,20%,20V	56289	196D107X0020MA3
C51	290-0531-00		CAP. ,FXD,ELCTLT:100UF,20%,10V	90201	TDC107M010WLC
C53	290-0531-00		CAP. ,FXD,ELCTLT:100UF,20%,10V	90201	TDC107M010WLC
C55	290-0531-00		CAP. ,FXD,ELCTLT:100UF,20%,10V	90201	TDC107M010WLC
C57	290-0531-00		CAP. ,FXD,ELCTLT:100UF,20%,10V	90201	TDC107M010WLC
J1	131-1499-01		CONN,RCPT,ELEC:72 PINS	80009	131-1499-01
J2	131-1499-01		CONN,RCPT,ELEC:72 PINS	80009	131-1499-01
J3	131-1499-01		CONN,RCPT,ELEC:72 PINS	80009	131-1499-01
J4	131-1499-01		CONN,RCPT,ELEC:72 PINS	80009	131-1499-01
J5	131-1499-01		CONN,RCPT,ELEC:72 PINS	80009	131-1499-01
J6	131-1499-01		CONN,RCPT,ELEC:72 PINS	80009	131-1499-01
J7	131-1499-01		CONN,RCPT,ELEC:72 PINS	80009	131-1499-01
J8	131-1499-01		CONN,RCPT,ELEC:72 PINS	80009	131-1499-01
J9	131-1499-01		CONN,RCPT,ELEC:72 PINS	80009	131-1499-01
J10	131-1499-01		CONN,RCPT,ELEC:72 PINS	80009	131-1499-01
J11	131-1499-01		CONN,RCPT,ELEC:72 PINS	80009	131-1499-01
J13A	131-1003-00		CONNECTOR BODY, :CKT BD MT, 3 PRONG	80009	131-1003-00
J13B	131-1003-00		CONNECTOR BODY, :CKT BD MT, 3 PRONG	80009	131-1003-00
J15A	131-1003-00		CONNECTOR BODY, :CKT BD MT, 3 PRONG	80009	131-1003-00
J15B	131-1003-00		CONNECTOR BODY, :CKT BD MT, 3 PRONG	80009	131-1003-00
J23A	131-1003-00		CONNECTOR BODY, :CKT BD MT, 3 PRONG	80009	131-1003-00
J23B	131-1003-00		CONNECTOR BODY, :CKT BD MT, 3 PRONG	80009	131-1003-00
J25A	131-1003-00		CONNECTOR BODY, :CKT BD MT, 3 PRONG	80009	131-1003-00
J25B	131-1003-00		CONNECTOR BODY, :CKT BD MT, 3 PRONG	80009	131-1003-00
J33A	131-1003-00		CONNECTOR BODY, :CKT BD MT, 3 PRONG	80009	131-1003-00
J33B	131-1003-00		CONNECTOR BODY, :CKT BD MT, 3 PRONG	80009	131-1003-00
J35A	131-1003-00		CONNECTOR BODY, :CKT BD MT, 3 PRONG	80009	131-1003-00
J35B	131-1003-00		CONNECTOR BODY, :CKT BD MT, 3 PRONG	80009	131-1003-00
J43A	131-1003-00		CONNECTOR BODY, :CKT BD MT, 3 PRONG	80009	131-1003-00

## Electrical Parts List—P7001 Main Interface

Ckt No.	Tektronix Part No.	Serial/Model No. Eff	No. Dscont	Name & Description	Mfr Code	Mfr Part Number
J43B	131-1003-00			CONNECTOR BODY, :CKT BD MT,3 PRONG	80009	131-1003-00
J45A	131-1003-00			CONNECTOR BODY, :CKT BD MT,3 PRONG	80009	131-1003-00
J45B	131-1003-00			CONNECTOR BODY, :CKT BD MT,3 PRONG	80009	131-1003-00
J53A	131-1003-00			CONNECTOR BODY, :CKT BD MT,3 PRONG	80009	131-1003-00
J53B	131-1003-00			CONNECTOR BODY, :CKT BD MT,3 PRONG	80009	131-1003-00
J55A	131-1003-00			CONNECTOR BODY, :CKT BD MT,3 PRONG	80009	131-1003-00
J55B	131-1003-00			CONNECTOR BODY, :CKT BD MT,3 PRONG	80009	131-1003-00
J63A	131-1003-00			CONNECTOR BODY, :CKT BD MT,3 PRONG	80009	131-1003-00
J63B	131-1003-00			CONNECTOR BODY, :CKT BD MT,3 PRONG	80009	131-1003-00
J65A	131-1003-00			CONNECTOR BODY, :CKT BD MT,3 PRONG	80009	131-1003-00
J65B	131-1003-00			CONNECTOR BODY, :CKT BD MT,3 PRONG	80009	131-1003-00
J73A	131-1003-00			CONNECTOR BODY, :CKT BD MT,3 PRONG	80009	131-1003-00
J73B	131-1003-00			CONNECTOR BODY, :CKT BD MT,3 PRONG	80009	131-1003-00
J75A	131-1003-00			CONNECTOR BODY, :CKT BD MT,3 PRONG	80009	131-1003-00
J75B	131-1003-00			CONNECTOR BODY, :CKT BD MT,3 PRONG	80009	131-1003-00

## P7001 Main Interface

### DPO DISASSEMBLY/ASSEMBLY INSTRUCTIONS

To remove the P7001 from the DPO, refer to Figure 5 and proceed as follows:

- a) Turn the DPO Power off.
- b) Disconnect J20 from the APD Interconnect board by pulling straight up on the handle on the connector. Set J20 in the safety-connector holder provided (Fig. 5A).
- c) Remove the four Phillips-head screws which hold the top decorative hinges closed. These hinges secure the Display Unit to the P7001. The Display Unit may be removed from the DPO when the hinges are open out and down (Fig. 5B).
- d) Loosen the two Phillips-head screws which secure the APD Interconnect board to the frame. Lift the APD Interconnect board and slide it up about one inch; then re-tighten the two screws (Fig. 5C).
- e) Remove the four Phillips-head screws which hold the bottom decorative hinges closed. These hinges secure the P7001 to the Acquisition Unit (Fig. 5C).
- f) The P7001 may now be removed from the Acquisition Unit (Fig. 5D). When removing the P7001, lift straight up so as not to damage the APD Interconnect board.

## P7001 Main Interface

### NOTE

*The Acquisition and Display Units can now be used as a normal oscilloscope by setting the Display Unit on the Acquisition Unit and reconnecting J20. However, use of these units in this manner will not meet 7704A specifications, since it has been calibrated as a DPO Unit. Do not re-calibrate as a 7704A if you plan to re-install the P7001.*

### Assembly

Repeat the above steps in reverse order for assembly of the DPO.

Top View of Main Interface  
Plug Connections

(Top level Coaxial Connectors  
not shown. See Fig. 4)

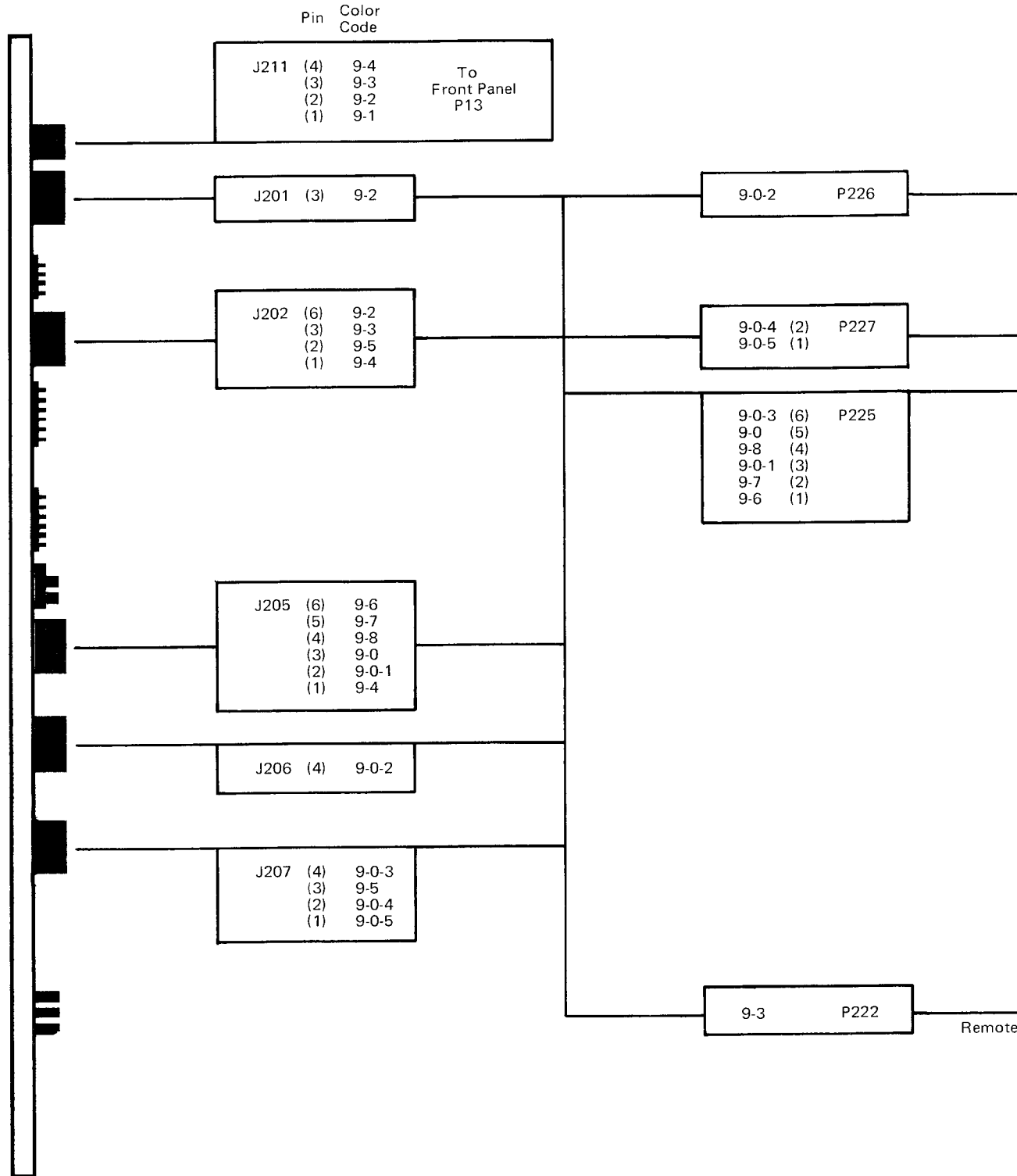

SIGNAL NAMES

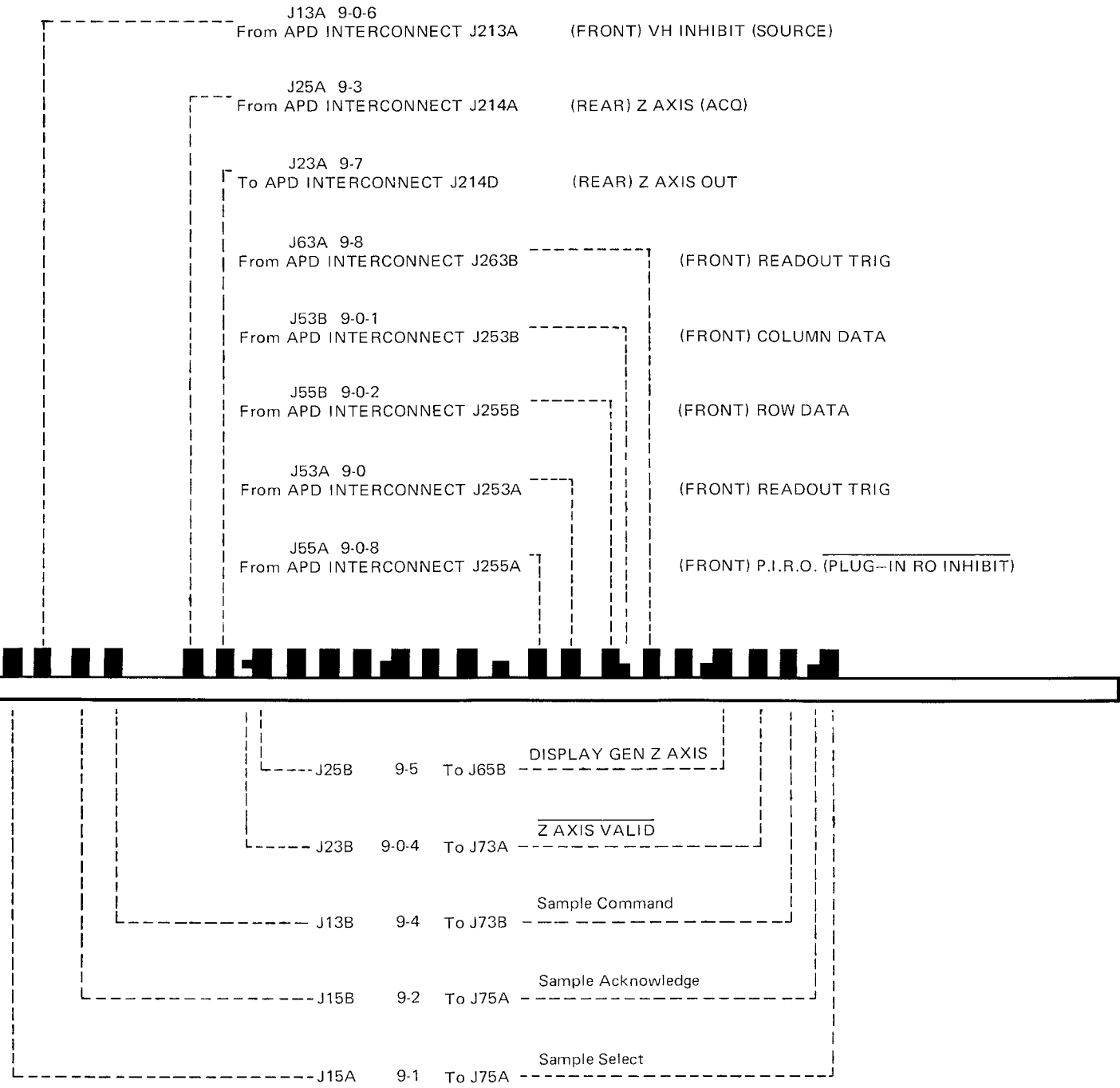

Top-Front view of Main Interface Tektronix Coaxial Connections.



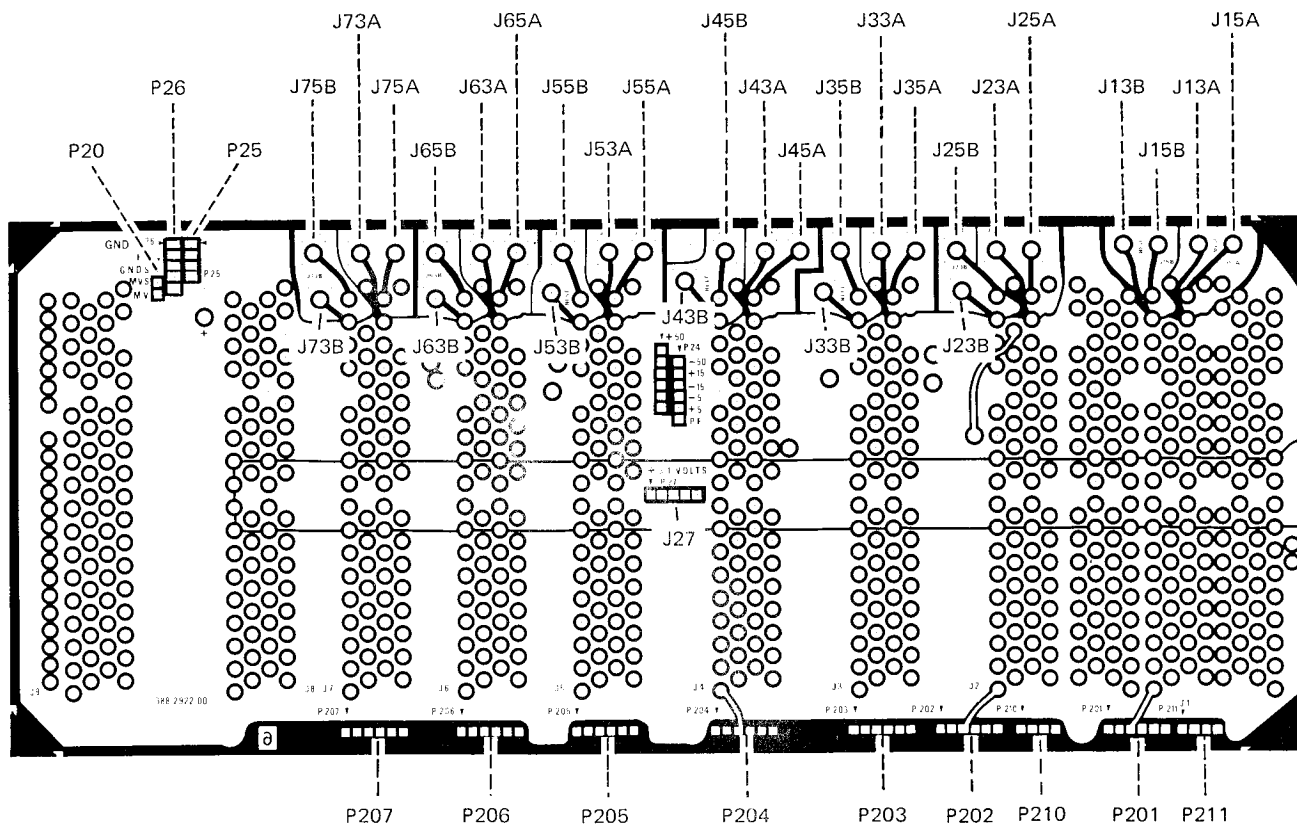

FIGURE 4 COAXIAL CABLING

Main Interface Board rear view

1604-04

Fig. 4 Main Interface Coaxial Connections.

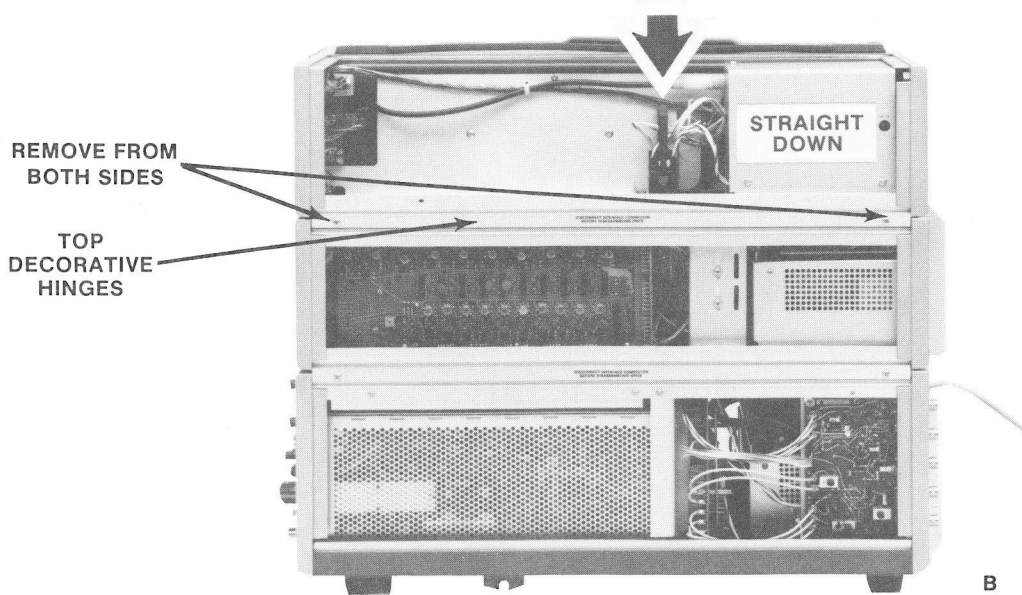
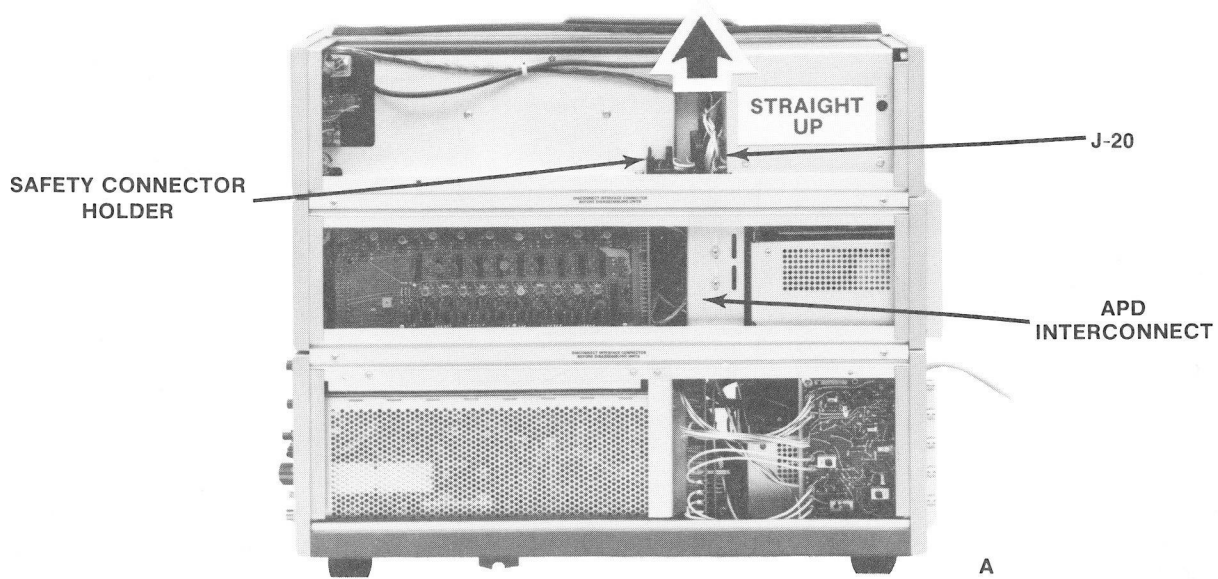

Fig. 5. DPO Disassembly/Assem

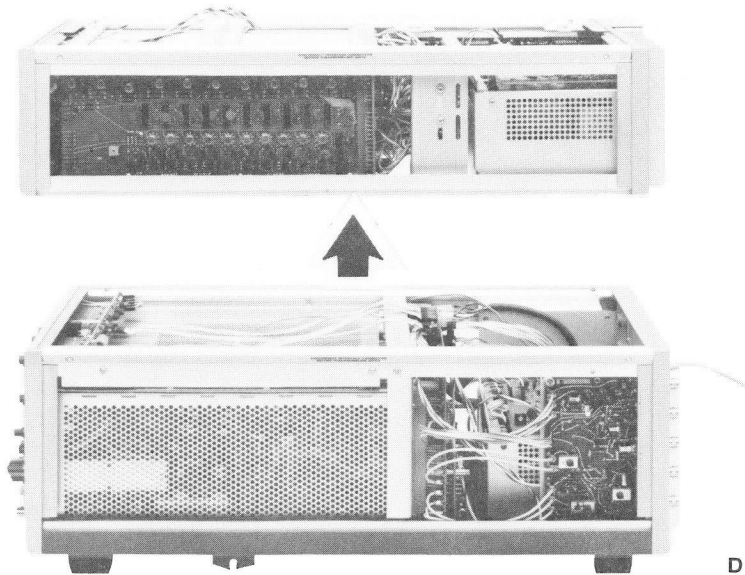
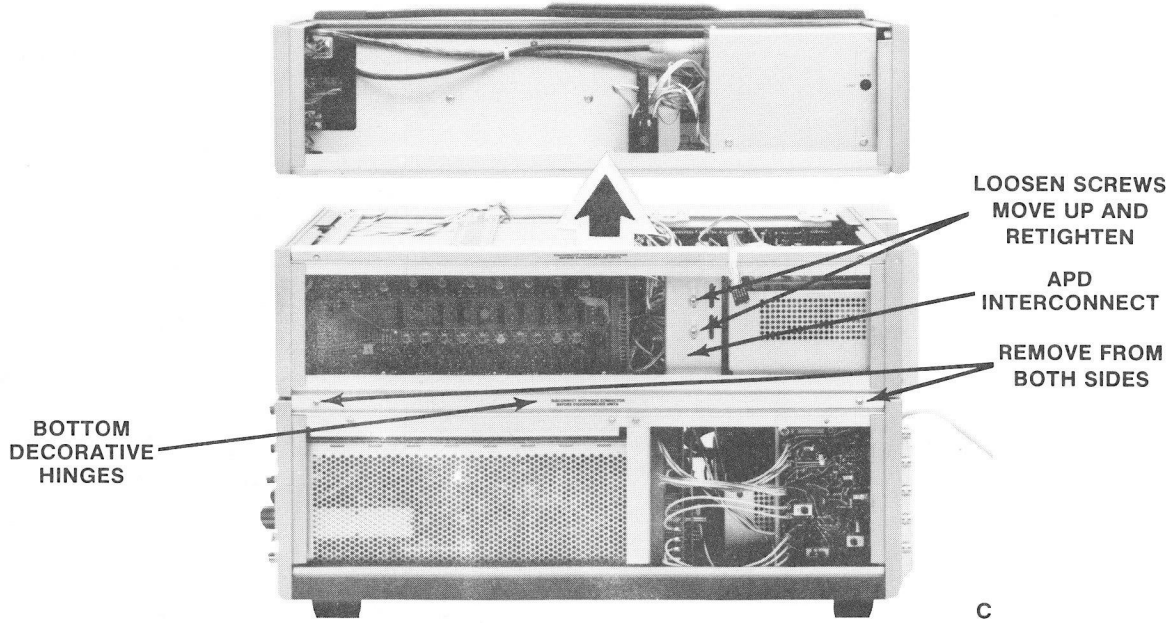
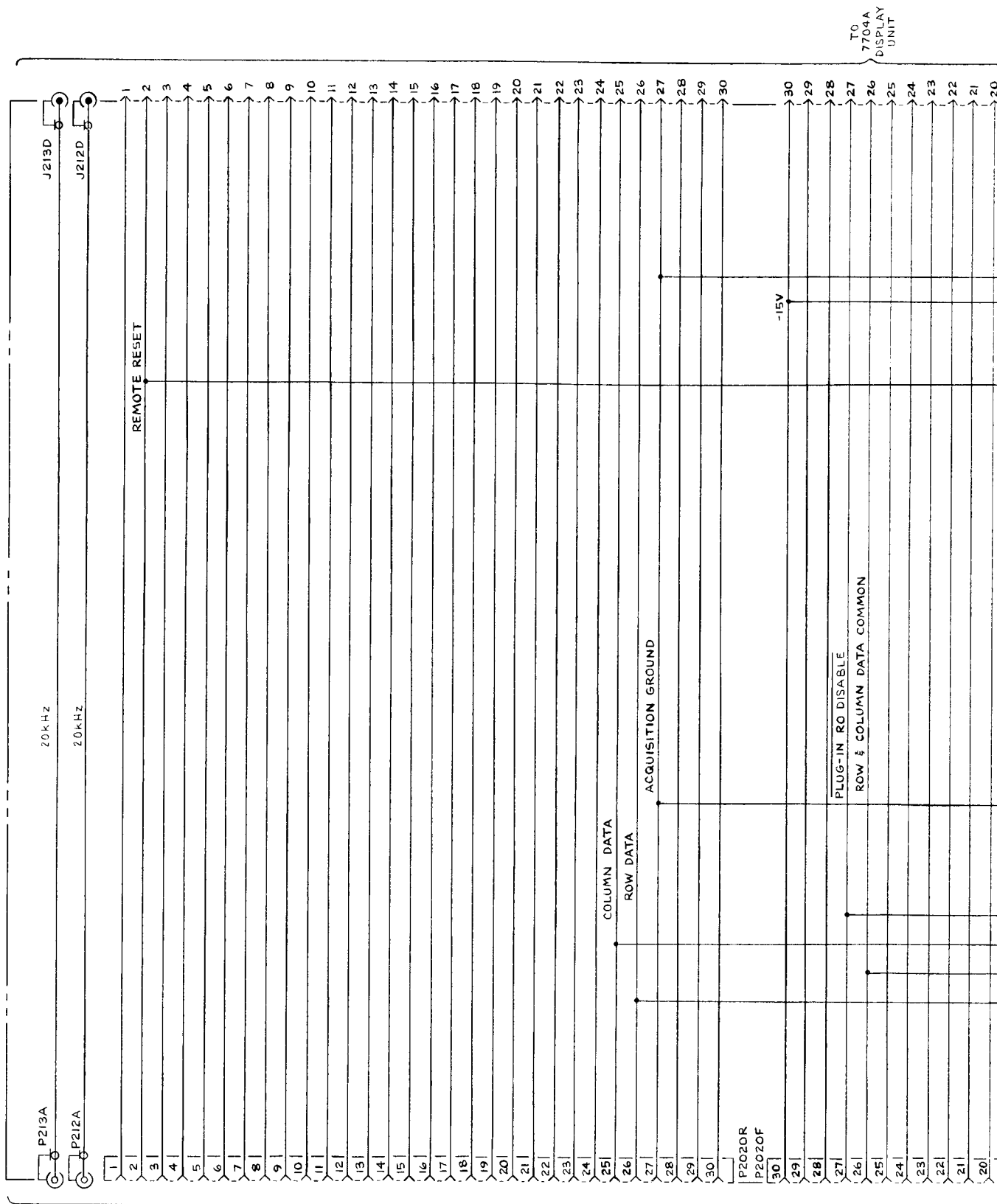

FIGURE 5 DPO DISASSEMBLY



+ P7001

FROM 7704A  
ACQUISITION  
UNIT



TO  
7704A  
DISPLAY  
UNIT

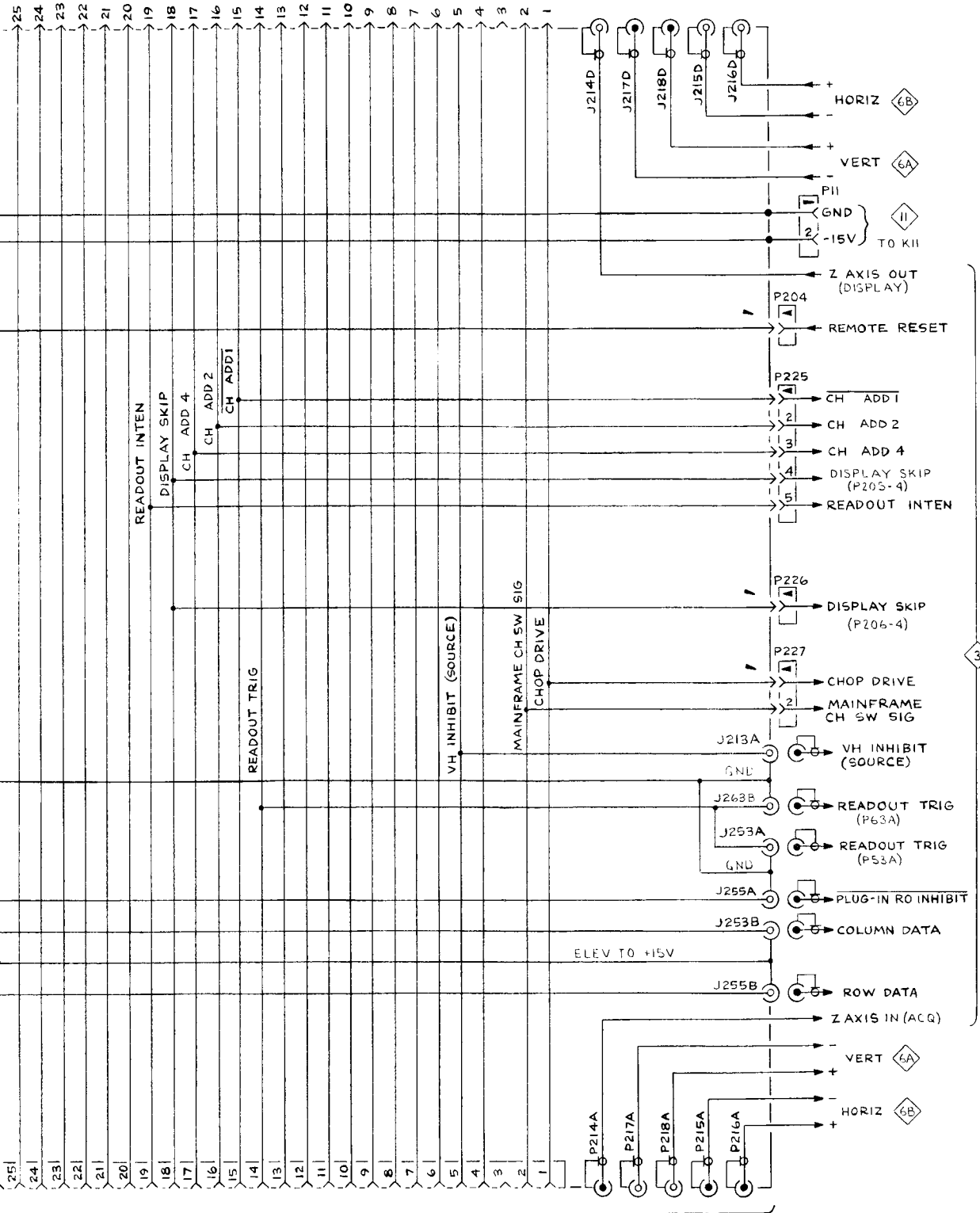

APD INTERCONNECT 2

NLL

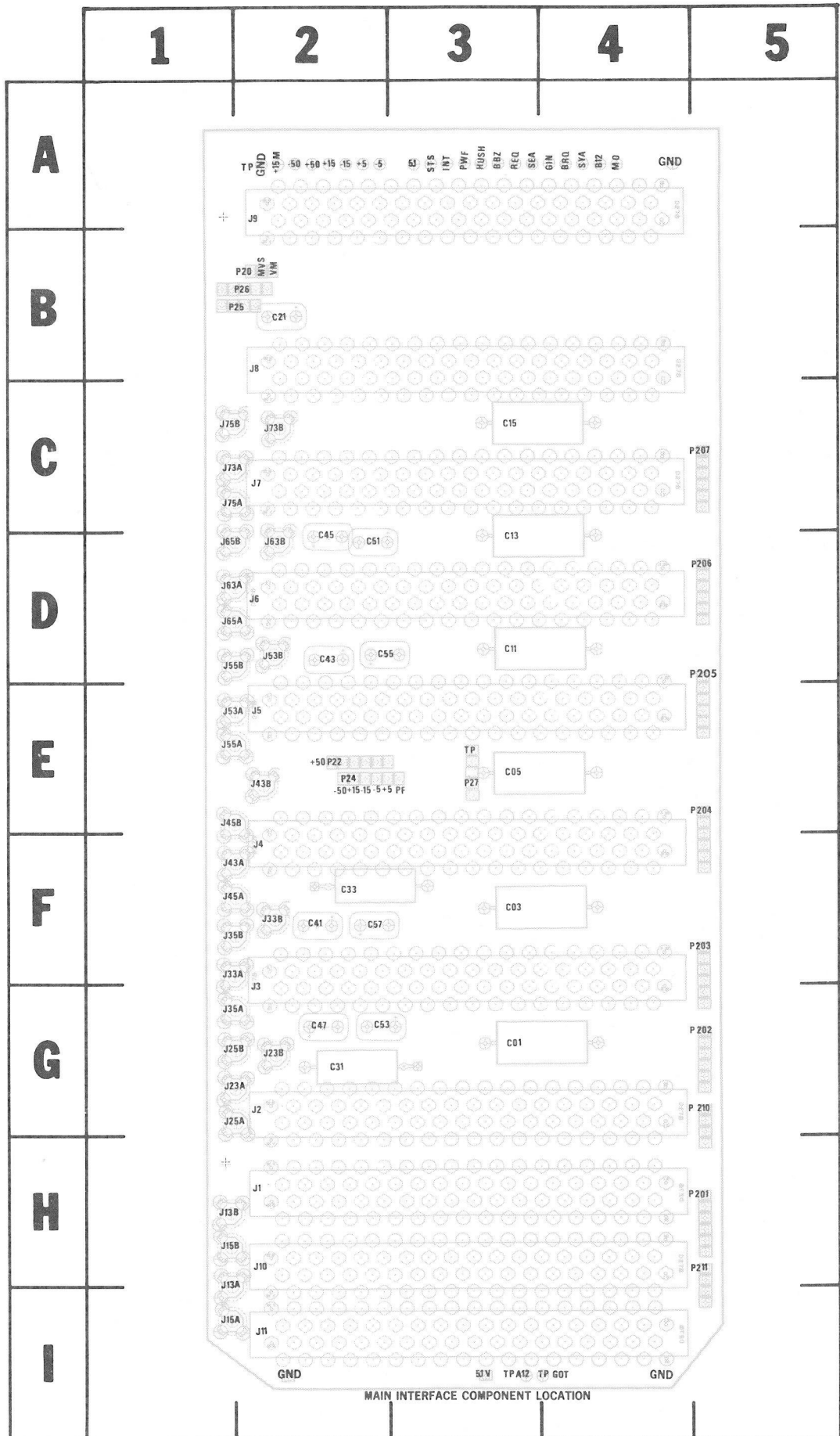

CKT NO	G L
C01	
C03	
C05	
C11	
C13	
C15	
C21	
C31	
C33	
C41	
C43	
C45	
C47	
C51	
C53	
C55	
C57	
J1	
J2	
J3	
J4	
J5	
J6	
J7	
J8	
J9	
J10	
J11	
J13A	
J13B	
J15A	
J15B	
J23A	
J23B	
J25A	
J25B	
J33A	
J33B	
J35A	
J35B	
J43A	
J43B	
J45A	
J45B	
J53A	
J53B	
J55A	
J55B	
J63A	
J63B	
J65A	
J65B	
J73A	
J73B	
J75A	
J75B	

FIGURE 6 COMPONENT LOCATION

GRID LOC	CKT NO	GRID LOC
G3	P20	B2
F3	P22	E2
E3	P24	E2
D3	P25	B2
D3	P26	B2
C3	P27	E3
B2	P201	H5
G2	P202	G5
F2	P203	F5
F2	P204	E5
D2	P205	D5
D2	P206	D5
G2	P207	C5
D2	P210	G5
G2	P211	H5
D2		
F2		
H2		
G2		
G2		
F2		
E2		
D2		
C2		
B2		
A2		
H2		
I2		
H1		
H1		
I1		
H1		
G1		
G2		
G1		
G1		
F1		
F2		
G1		
F1		
F1		
E2		
F1		
E1		
E1		
D2		
E1		
D1		
D1		
D2		
D1		
D1		
C1		
C2		
C1		
C1		

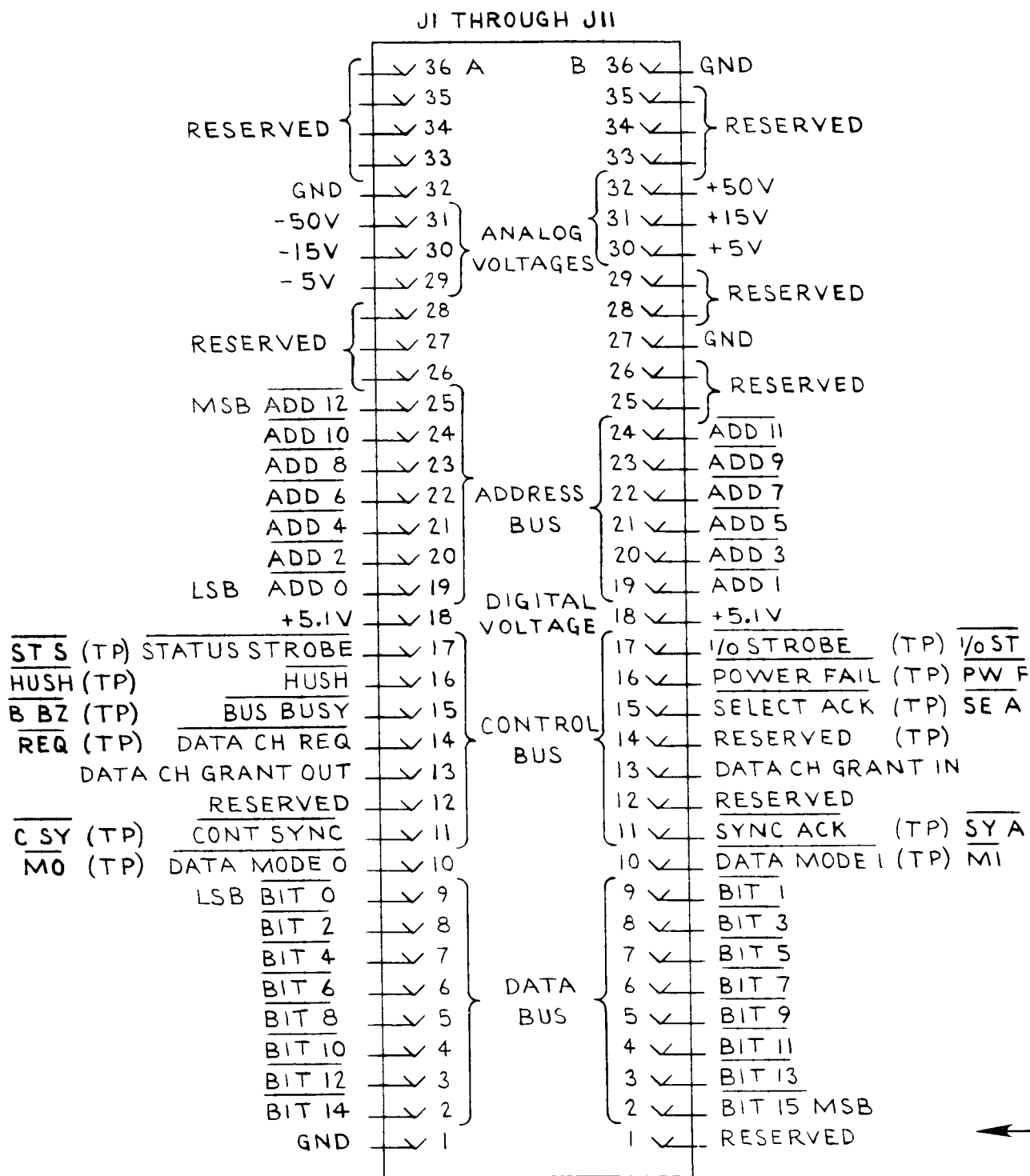
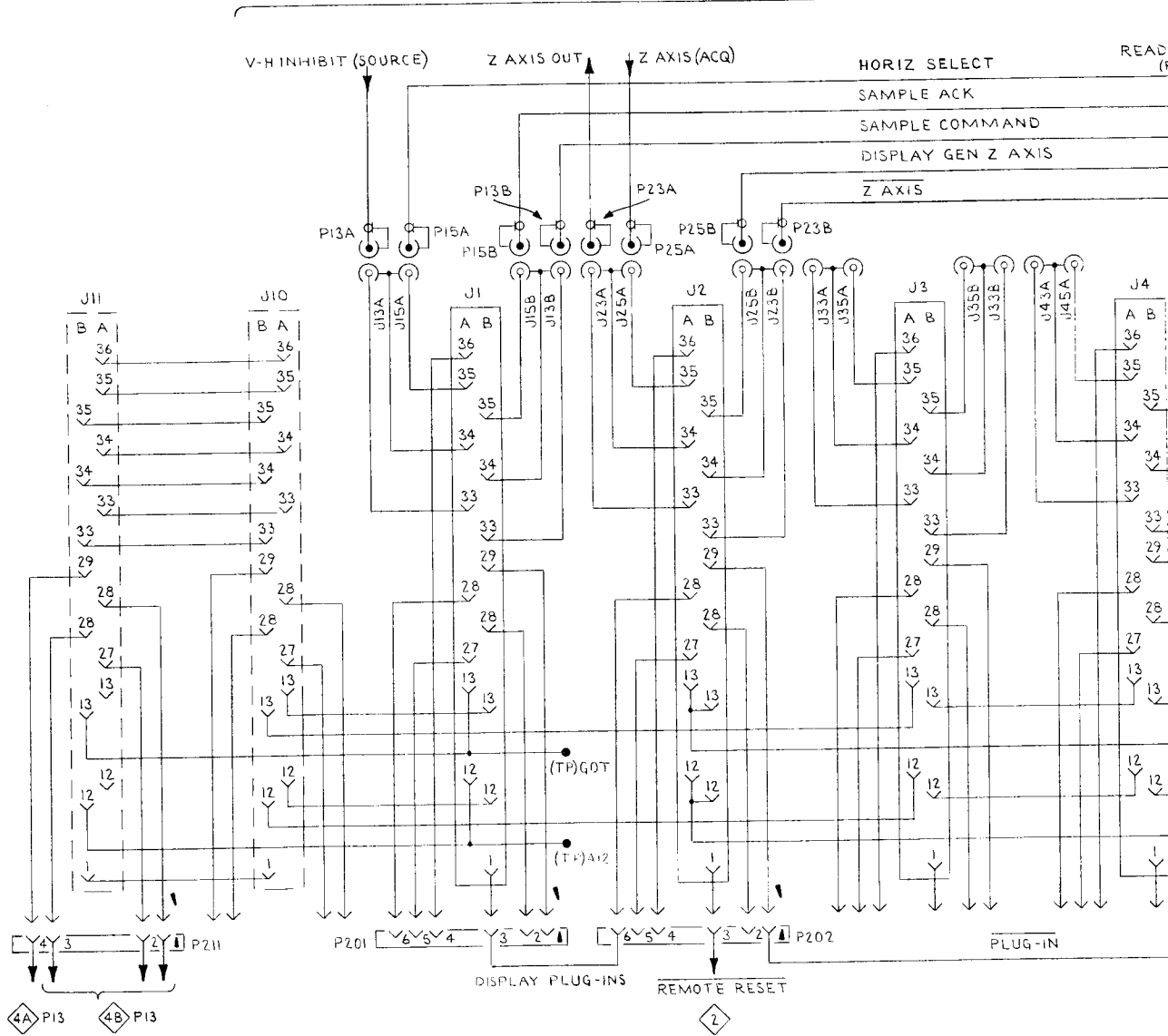

Fig. 7. Common Bus Pin Termination.





**CARD TO CONNECTOR ASSIGNMENT**

- J1 SAMPLE & HOLD OR DISPLAY MULTIPLEXER
- J2 Z AXIS/FRONT PANEL
- J3 SPARE
- J4 SPARE
- J5 READOUT INTERFACE
- J6 DISPLAY GENERATOR
- J7 A-D CONVERTER
- J8 MEMORY
- J9 MEMORY
- J10 I/O 1
- J11 I/O 2

← Fig. 7

3

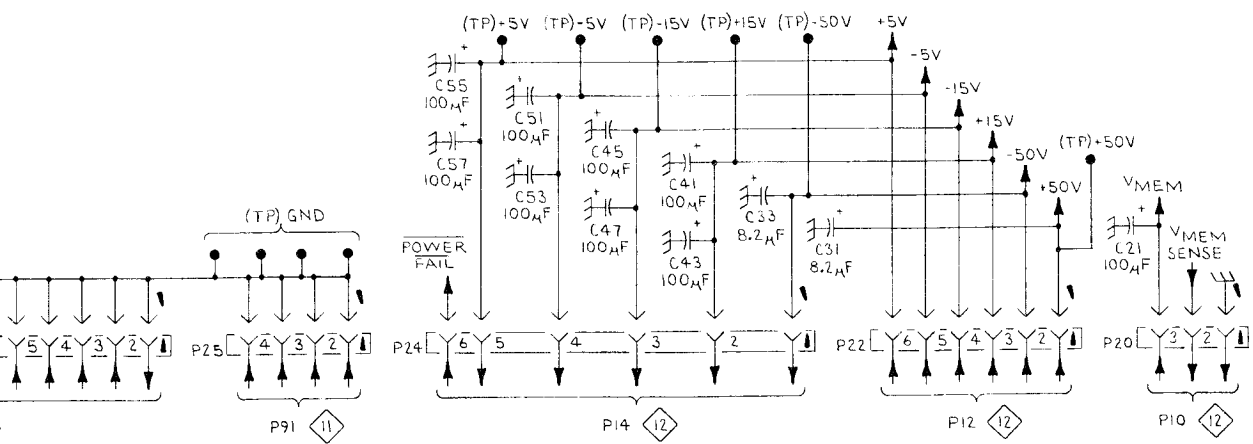
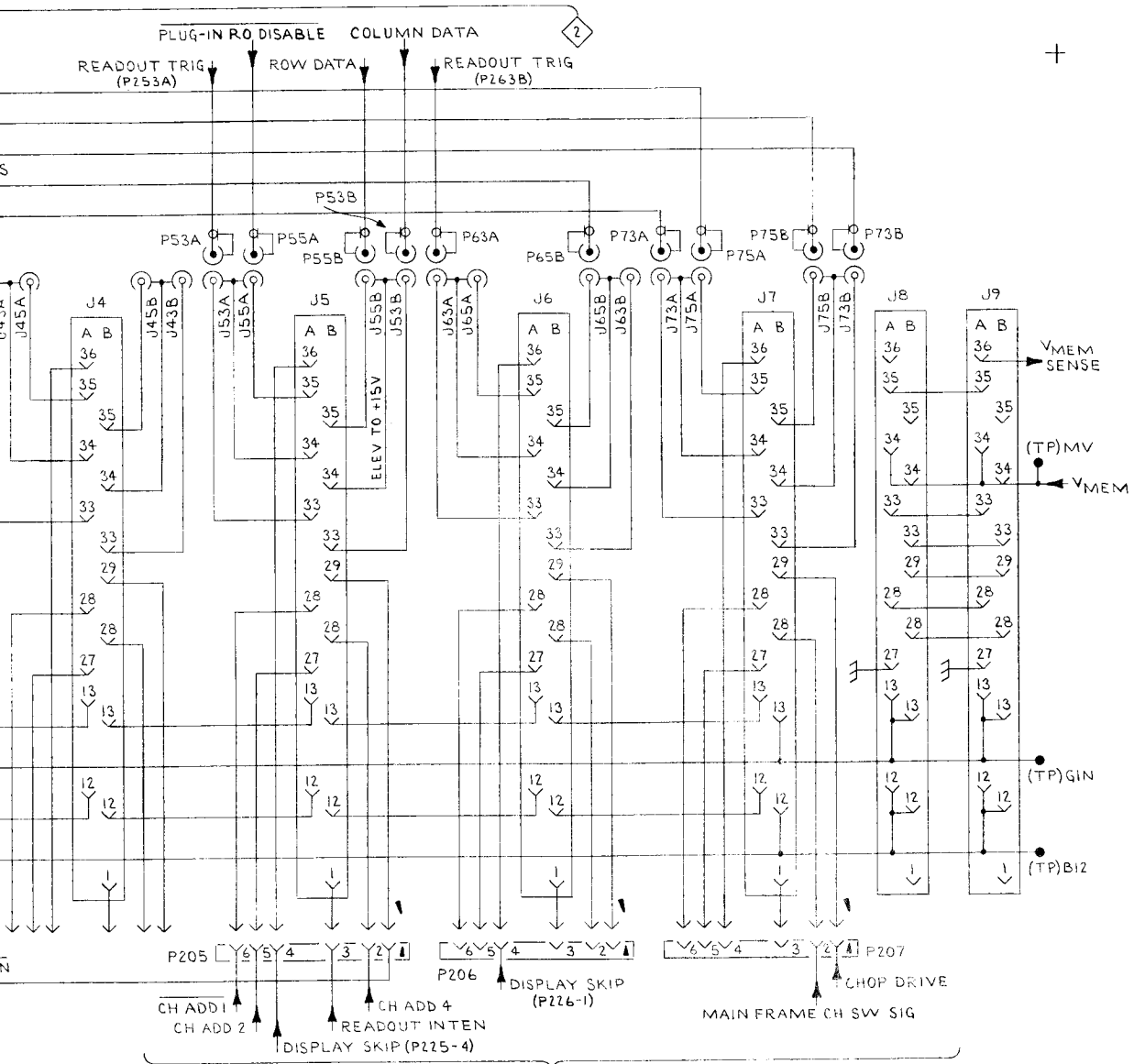

# REPLACEABLE MECHANICAL PARTS

## PARTS ORDERING INFORMATION

Replacement parts are available from or through your local Tektronix, Inc. Field Office or representative.

Changes to Tektronix instruments are sometimes made to accommodate improved components as they become available, and to give you the benefit of the latest circuit improvements developed in our engineering department. It is therefore important, when ordering parts, to include the following information in your order: Part number, instrument type or number, serial number, and modification number if applicable.

If a part you have ordered has been replaced with a new or improved part, your local Tektronix, Inc. Field Office or representative will contact you concerning any change in part number.

Change information, if any, is located at the rear of this manual.

## SPECIAL NOTES AND SYMBOLS

- X000 Part first added at this serial number
- 00X Part removed after this serial number

## FIGURE AND INDEX NUMBERS

Items in this section are referenced by figure and index numbers to the illustrations.

## INDENTATION SYSTEM

This mechanical parts list is indented to indicate item relationships. Following is an example of the indentation system used in the description column.

```

1 2 3 4 5           Name & Description
Assembly and/or Component
Attaching parts for Assembly and/or Component
  --- * ---
Detail Part of Assembly and/or Component
Attaching parts for Detail Part
  --- * ---
Parts of Detail Part
Attaching parts for Parts of Detail Part
  --- * ---
    
```

Attaching Parts always appear in the same indentation as the item it mounts, while the detail parts are indented to the right. Indented items are part of, and included with, the next higher indentation. The separation symbol --- \* --- indicates the end of attaching parts.

**Attaching parts must be purchased separately, unless otherwise specified.**

## ITEM NAME

In the Parts List, an Item Name is separated from the description by a colon (:). Because of space limitations, an Item Name may sometimes appear as incomplete. For further Item Name identification, the U.S. Federal Cataloging Handbook H6-1 can be utilized where possible.

## ABBREVIATIONS

INCH	ELCTRN	ELECTRON	IN	INCH	SE	SINGLE END
#	ELEC	ELECTRICAL	INCAND	INCANDESCENT	SECT	SECTION
ACTR	ELCTLT	ELECTROLYTIC	INSUL	INSULATOR	SEMICON	SEMICONDUCTOR
ADPTR	ELEM	ELEMENT	INTL	INTERNAL	SHLD	SHIELD
ALIGN	EPL	ELECTRICAL PARTS LIST	LPHLDR	LAMPHOLDER	SHLDR	SHOULDERED
AL	EQPT	EQUIPMENT	MACH	MACHINE	SKT	SOCKET
ASSEM	EXT	EXTERNAL	MECH	MECHANICAL	SL	SLIDE
ASSY	FIL	FILLISTER HEAD	MTG	MOUNTING	SLFLKG	SELF-LOCKING
ATTEN	FLEX	FLEXIBLE	NIP	NIPPLE	SLVG	SLEEVEING
AWG	FLH	FLAT HEAD	NON WIRE	NOT WIRE WOUND	SPR	SPRING
BD	FLTR	FILTER	OD	ORDER BY DESCRIPTION	SQ	SQUARE
BRKT	FR	FRAME or FRONT	OD	OUTSIDE DIAMETER	SST	STAINLESS STEEL
BRS	FSTNR	FASTENER	OVB	OVAL HEAD	STL	STEEL
BRZ	FT	FOOT	PH BRZ	PHOSPHOR BRONZE	SW	SWITCH
BSHG	FXD	FIXED	PL	PLAIN or PLATE	T	TUBE
CAB	GSKT	GASKET	PLSTC	PLASTIC	TERM	TERMINAL
CAP	HDL	HANDLE	PN	PART NUMBER	THD	THREAD
CER	HEX	HEXAGON	PNH	PAN HEAD	THK	THICK
CHAS	HEX HD	HEXAGONAL HEAD	PWR	POWER	TNSN	TENSION
CKT	HEX SOC	HEXAGONAL SOCKET	RCPT	RECEPTACLE	TPG	TAPPING
COMP	HLCPS	HELICAL COMPRESSION	RES	RESISTOR	TRH	TRUSS HEAD
CONN	HLEXT	HELICAL EXTENSION	RGD	RIGID	V	VOLTAGE
COV	HV	HIGH VOLTAGE	RLF	RELIEF	VAR	VARIABLE
CPLG	IC	INTEGRATED CIRCUIT	RTNR	RETAINER	W/	WITH
CRT	ID	INSIDE DIAMETER	SCH	SOCKET HEAD	WSHR	WASHER
DEG	IDENT	IDENTIFICATION	SCOPE	OSCILLOSCOPE	XFMR	TRANSFORMER
DWR	IMPLR	IMPELLER	SCR	SCREW	XSTR	TRANSISTOR

Mechanical Parts List—P7001 Main Interface

**CROSS INDEX MFR. CODE NUMBER TO MANUFACTURER**

<b>MFR.CODE</b>	<b>MANUFACTURER</b>	<b>ADDRESS</b>	<b>CITY,STATE,ZIP</b>
00779	AMP, Inc.	P. O. Box 3608	Harrisburg, PA 17105
08261	Spectra-Strip Corp.	7100 Lampson Ave.	Garden Grove, CA 92642
12327	Freeway Corp.	9301 Allen Dr.	Cleveland, OH 44125
13257	Amerace Ltd.	10 Esna Park Dr.	Markham, Ontario, Canada
22526	Berg Electronics, Inc.	Youk Expressway	New Cumberland, PA 17070
23499	Gavitt Wire and Cable, Division of RSC Industries, Inc.	455 N. Quince St.	Escondido, CA 92025
78189	Illinois Tool Works, Inc. Shakeproof Division	St. Charles Road	Elgin, IL 60120
80009	Tektronix, Inc.	P. O. Box 500	Beaverton, OR 97077
83385	Central Screw Co.	2530 Crescent Dr.	Broadview, IL 60153
83501	Gavitt Wire and Cable, Division of RSC Industries, Inc.	Central St.	Brookfield, MA 01506
95987	Weckesser Co., Inc.	4444 West Irving Park Rd.	Chicago, IL 60641

Mechanical Parts List—P7001 Main Interface

Fig. & Index No.	Tektronix Part No.	Serial/Model No. Eff	No. Dscont	Qty	1	2	3	4	5	Name & Description	Mfr Code	Mfr Part Number
1-1	426-0809-02			1						FRAME PNL,CAB:FRONT (ATTACHING PARTS)	80009	426-0809-02
-2	213-0270-00			4						SCR,TPG,THD FOR:10-32 X 0.75 INCH FILH STL - - - * - - -	83385	OBD
-3	214-1744-00			1						HINGE HALF:REAR (ATTACHING PARTS)	80009	214-1744-00
-4	211-0017-00			2						SCREW,MACHINE:4-40 X 0.375 INCH,PNH STL	83385	OBD
-5	210-0589-00			2						NUT,SELF LKG HE:4-40 X 0.250 INCH - - - * - - -	13257	22 NM-40
-6	358-0216-00			4						BUSHING,PLASTIC:0.257 ID X 0.412 INCH OD	80009	358-0216-00
-7	407-1195-00			2						BRACKET,ANGLE:HINGE MTG (ATTACHING PARTS FOR EACH)	80009	407-1195-00
-8	211-0008-00			2						SCREW,MACHINE:4-40 X 0.25 INCH,PNH STL - - - * - - -	83385	OBD
-9	343-0002-00			2						CLAMP,LOOP:0.188 INCH DIA (ATTACHING PARTS FOR EACH)	95987	3-16-6B
-10	211-0097-00			1						SCREW,MACHINE:4-40 X 0.312 INCH,PNH STL	83385	OBD
-11	210-0994-00			1						WASHER,FLAT:0.125 ID X 0.25" OD,STL	83385	OBD
-12	210-0586-00			1						NUT,PLAIN,EXT W:4-40 X 0.25 INCH,STL - - - * - - -	78189	OBD
-13	343-0042-00			2						CLAMP,LOOP:0.287 INCH DIA (ATTACHING PARTS FOR EACH)	95987	5-16-6BH
-14	211-0097-00			1						SCREW,MACHINE:4-40 X 0.312 INCH,PNH STL	83385	OBD
-15	210-0863-00			1						WSHR,LOOP CLAMP:FOR 0.50" WIDE CLAMP,STL	95987	C191
-16	210-0586-00			1						NUT,PLAIN,EXT W:4-40 X 0.25 INCH,STL - - - * - - -	78189	OBD
-17	129-0406-00			1						SPACER,POST:0.188 HEX X 4.619 INCH LONG (ATTACHING PARTS)	80009	129-0406-00
-18	211-0097-00			2						SCREW,MACHINE:4-40 X 0.312 INCH,PNH STL - - - * - - -	83385	OBD
-19	337-1758-00			1						SHIELD,ELEC:4.619 X 10.265 INCH LONG (ATTACHING PARTS)	80009	337-1758-00
-20	211-0008-00			4						SCREW,MACHINE:4-40 X 0.25 INCH,PNH STL	83385	OBD
-21	210-0586-00			4						NUT,PLAIN,EXT W:4-40 X 0.25 INCH,STL - - - * - - -	78189	OBD
-22	351-0087-00			36						GUIDE,CKT CARD:4.75 INCH LONG,PLASTIC	80009	351-0087-00
-23	386-2135-00			1						SUPPORT,GUIDE:10.320 INCH LONG,FRONT (ATTACHING PARTS)	80009	386-2135-00
-24	211-0097-00			2						SCREW,MACHINE:4-40 X 0.312 INCH,PNH STL	83385	OBD
-25	211-0008-00			2						SCREW,MACHINE:4-40 X 0.25 INCH,PNH STL	83385	OBD
-26	210-0586-00			4						NUT,PLAIN,EXT W:4-40 X 0.25 INCH,STL - - - * - - -	78189	OBD
-27	105-0425-00			1						STOP,CKT BOARD:10.320 INCH LONG,FRONT	80009	105-0425-00
-28	386-2135-00			1						SUPPORT,GUIDE:10.320 INCH LONG,FRONT (ATTACHING PARTS)	80009	386-2135-00
-29	211-0008-00			2						SCREW,MACHINE:4-40 X 0.25 INCH,PNH STL	83385	OBD
-30	210-0586-00			2						NUT,PLAIN,EXT W:4-40 X 0.25 INCH,STL - - - * - - -	78189	OBD
-31	386-2134-00			2						SUPPORT,GUIDE:10.320 INCH LONG,CENTER (ATTACHING PARTS FOR EACH)	80009	386-2134-00
-32	211-0008-00			2						SCREW,MACHINE:4-40 X 0.25 INCH,PNH STL	83385	OBD
-33	210-0586-00			2						NUT,PLAIN,EXT W:4-40 X 0.25 INCH,STL - - - * - - -	78189	OBD
-34	388-2948-00			3						CIRCUIT BOARD:DATA CH.JUMPER	80009	388-2948-00
-35	-----			1						CKT BOARD ASSY:MAIN INTERFACE (ATTACHING PARTS)		
-36	211-0007-00			6						SCREW,MACHINE:4-40 X 0.188 INCH,PNH STL - - - * - - -	83385	OBD
-37	131-1003-00			28						. CKT BOARD ASSY INCLUDES: . CONNECTOR BODY,:CKT BD MT,3 PRONG	80009	131-1003-00
-38	136-0252-04			28						. CONTACT,ELEC:0.188 INCH LONG	22526	75060
-39	131-1343-00			78						. CONT ASSY,ELEC:	22526	65274-2
-40	131-1499-01			11						. CONN,RCPT,ELEC:72 PIN (J1-J11)	80009	131-1499-01

# Mechanical Parts List—P7001 Main Interface

Fig. & Index No.	Tektronix Part No.	Serial/Model No. Eff Dscont	Qty	1	2	3	4	5	Name & Description	Mfr Code	Mfr Part Number
1-41	214-0579-00		29	.					TERM.,TEST PT:0.40 INCH LONG	80009	214-0579-00
-42	220-0547-01		6	.					NUT,BLOCK:0.38 X 0.25 X 0.282"OA (ATTACHING PARTS FOR EACH)	80009	220-0547-01
-43	211-0007-00		6	.					SCREW,MACHINE:4-40 X 0.188 INCH,PNH STL - - - * - - -	83385	OBD
-44	179-1847-00		1	.					WIRING HARNESS:MAIN INTERFACE	80009	179-1847-00
-45	131-0707-00		22	.	.				CONTACT,ELEC:0.48"L,22-26 AWG WIRE	22526	47439
-46	352-0163-05		1	.	.				HOLDER,TERM.CONN:5 WIRE GREEN	80009	352-0163-05
-47	352-0164-01		1	.	.				HOLDER,TERM.CONN:6 WIRE BROWN	80009	352-0164-01
	352-0164-02		1	.	.				HOLDER,TERM.CONN:6 WIRE RED	80009	352-0164-02
	352-0164-05		1	.	.				HOLDER,TERM.CONN:6 WIRE GREEN	80009	352-0164-05
	352-0164-06		1	.	.				HOLDER,TERM.CONN:6 WIRE BLUE	80009	352-0164-06
	352-0164-07		1	.	.				HOLDER,TERM.CONN:6 WIRE VIOLET	80009	351-0164-07
-48	352-0169-07		1	.	.				HOLDER,TERM.CONN:2 WIRE VIOLET	80009	352-0169-07
-49	352-0171-04		1	.	.				HOLDER,TERM.CONN:1 WIRE YELLOW	80009	352-0171-04
	352-0171-06		1	.	.				HOLDER,TERM.CONN:1 WIRE BLUE	80009	352-0171-06
-50	175-1255-00		FT	.					CABLE,RF:50 OHM,COAX,3.35 FT	80009	175-0255-00
-51	210-0774-00		10	.					EYELET,METALLIC:0.152 OD X 0.245 INCH L,BRS	80009	210-0774-00
-52	210-0775-00		10	.					EYELET,METALLIC:0.126 OD X 0.23 INCH L,BRS	80009	210-0775-00
-53	386-2139-00		2	.					SUPPORT,GUIDE:10.320 INCH LONG,REAR (ATTACHING PARTS FOR EACH)	80009	386-2139-00
-54	211-0008-00		2	.					SCREW,MACHINE:4-40 X 0.25 INCH,PNH STL	83385	OBD
-55	210-0586-00		2	.					NUT,PLAIN,EXT W:4-40 X 0.25 INCH,STL - - - * - - -	78189	OBD
-56	351-0179-02		4	.					GUIDE,CKT BOARD:0.30 X 6.75 INCH L,PLSTC (ATTACHING PARTS FOR EACH)	80009	351-0179-02
-57	211-0008-00		2	.					SCREW,MACHINE:4-40 X 0.25 INCH,PNH STL - - - * - - -	83385	OBD
-58	386-2283-00		4	.					SUPPORT,GUIDE:1.50 INCH SQ,AL (ATTACHING PARTS FOR EACH)	80009	386-2283-00
-59	211-0101-00		2	.					SCREW,MACHINE:4-40 X 0.25" 100 DEG,FLH STL - - - * - - -	83385	OBD
-60	210-0201-00		1	.					TERMINAL,LUG:SE #4 (ATTACHING PARTS)	78189	2104-04-00-2520N
-61	211-0008-00		1	.					SCREW,MACHINE:4-40 X 0.25 INCH,PNH STL	83385	OBD
-62	210-0551-00		1	.					NUT,PLAIN,HEX.:4-40 X 0.25 INCH,STL - - - * - - -	83385	OBD
-63	-----		1	.					CKT BOARD ASSY:APD INTERCONNECT (ATTACHING PARTS)		
-64	211-0008-00		2	.					SCREW,MACHINE:4-40 X 0.25 INCH,PNH STL	83385	OBD
-65	210-0851-00		2	.					WASHER,FLAT:0.119 ID X 0.375 INCH OD,STL - - - * - - -	12327	OBD
-66	131-0589-00		1	.					CKT BOARD ASSY INCLUDES: CONTACT,ELEC:0.46 INCH LONG	22526	47350
-67	131-1003-00		6	.					CONNECTOR BODY,:CKT BD MT,3 PRONG	80009	131-1003-00
-68	136-0252-04		6	.					CONTACT,ELEC:0.188 INCH LONG	22526	75060
-69	131-1250-01		1	.					CONN,RCPT,ELEC:60 PINS (ATTACHING PARTS)	80009	131-1250-01
-70	211-0012-00		2	.					SCREW,MACHINE:4-40 X 0.375 INCH,PNH STL - - - * - - -	83385	OBD
-71	441-1047-00		1	.					CHASSIS,SCOPE:CKT BOARD MTG (ATTACHING PARTS)	80009	441-1047-00
-72	211-0008-00		4	.					SCREW,MACHINE:4-40 X 0.25 INCH,PNH STL	83385	OBD
-73	210-0586-00		4	.					NUT,PLAIN,EXT W:4-40 X 0.25 INCH,STL - - - * - - -	78189	OBD
-74	380-0262-00		4	.					HOUSING,CONN: (ATTACHING PARTS FOR EACH)	80009	380-0262-00
-75	211-0097-00		1	.					SCREW,MACHINE:4-40 X 0.312 INCH,PNH STL	83385	OBD
-76	210-0551-00		1	.					NUT,PLAIN,HEX.:4-40 X 0.25 INCH,STL - - - * - - -	83385	OBD
-77	361-0566-00		2	.					SPACER,CONN:0.44 X 3.15 INCH LONG	80009	361-0566-00
-78	175-0825-00		FT	.					WIRE,ELECTRICAL:2 WIRE RIBBON	23499	TEK-175-0825-00
-79	131-0707-00		2	.					CONTACT,ELEC:0.48"L,22-26 AWG WIRE	22526	47439

Mechanical Parts List—P7001 Main Interface

Fig. & Index No.	Tektronix Part No.	Serial/Model No. Eff Dscont	Qty						Name & Description	Mfr Code	Mfr Part Number	
				1	2	3	4	5			Mfr	Part Number
1-80	352-0169-00		1						. HOLDER,TERM.CON:2 WIRE BLACK	80009	352-0169-00	
-81	175-1255-00		FT						. CABLE,RF:50 OHM,COAX,14.833 FT	80009	175-1255-00	
-82	131-1101-00		7						. CONTACT,ELEC:MALE	00779	51563-1	
-83	131-1102-00		7						. CONTACT,ELEC:FEMALE	00779	51565-1	
-84	166-0532-00		14						. FURRULE,RF CA:SLEEVE	00779	1-332056-0	
-85	210-0774-00		22						. EYELET,METALLIC:0.152 OD X 0.245 INCH L,BRS	80009	210-0774-00	
-86	210-0775-00		22						. EYELET,METALLIC:0.126 OD X 0.23 INCH L,BRS	80009	210-0775-00	
-87	386-2140-00		1						SUPPORT,CHASSIS:CKT BOARD MTG (ATTACHING PARTS)	80009	386-2140-00	
-88	211-0008-00		4						SCREW,MACHINE:4-40 X 0.25 INCH,PNH STL	83385	OBD	
-89	210-0586-00		4						NUT,PLAIN,EXT W:4-40 X 0.25 INCH,STL - - - * - - - -	78189	OBD	
-90	426-0849-00		2						FRAME SECT,CAB:COUPLING	80009	426-0849-00	
-91	426-0809-03		1						FRAME PNL,CAB:REAR (ATTACHING PARTS)	80009	426-0809-03	
-92	213-0270-00		4						SCR,TPG,THD FOR:10-32 S 0.75 INCH,FILH STL - - - * - - - -	83385	OBD	
-93	426-0853-00		1						FRAME SECT,CAB:UPPER LEFT	80009	426-0853-00	
-94	426-0856-00		1						FRAME SECT,CAB:LOWER LEFT	80009	426-0856-00	
-95	426-0854-00		1						FRAME SECT,CAB:UPPER RIGHT	80009	426-0854-00	
-96	426-0855-00		1						FRAME SECT,CAB:LOWER RIGHT	80009	426-0855-00	
-97	175-0826-00		FT						WIRE,ELECTRICAL:3 WIRE RIBBON,0.646 FT	08261	TEK-175-0826-00	
-98	175-0827-00		FT						WIRE,ELECTRICAL:4 WIRE RIBBON,1.646 FT	08261	TEK-175-0827-00	
	175-0861-00		FT						WIRE,ELECTRICAL:4 WIRE RIBBON,0.563 FT	23499	TEK-175-0861-00	
-99	175-0860-00		FT						WIRE,ELECTRICAL:5 WIRE RIBBON,1.104 FT	23499	TEK-175-0860-00	
-100	175-0829-00		FT						WIRE,ELECTRICAL:6 WIRE RIBBON,0.667 FT	83501	TEK-175-0829-00	
	175-0859-00		FT						WIRE,ELECTRICAL:6 WIRE RIBBON,0.688 FT	23499	TEK-175-0859-00	
-101	131-0707-00		FT						CONTACT,ELEC:0.48"L,22-26 AWG WIRE	22526	47439	
-102	352-0161-00		2						HOLDER,TERM.CON:3 WIRE BLACK	80009	352-0161-00	
-103	352-0162-01		2						HOLDER,TERM.CON:4 WIRE BROWN	80009	352-0162-01	
	352-0162-03		1						HOLDER,TERM.CON:4 WIRE ORANGE	80009	352-0162-03	
	352-0162-05		1						HOLDER,TERM.CON:4 WIRE GREEN	80009	352-0162-05	
-104	352-0163-06		1						HOLDER,TERM.CON:5 WIRE BLUE	80009	352-0163-06	
	352-0163-07		1						HOLDER,TERM.CON:5 WIRE VIOLET	80009	352-0163-07	
-105	352-0164-02		2						HOLDER,TERM.CON:6 WIRE RED	80009	352-0164-02	
	352-0164-04		2						HOLDER,TERM.CON:6 WIRE YELLOW	80009	352-0164-04	
-106	352-0168-01		1						HOLDER,TERM.CON:10 WIRE BROWN	80009	352-0168-01	
-107	175-1255-00		FT						CABLE,RF:50 OHM,CAOX,6.583 FT	80009	175-1255-00	
-108	210-0774-00		10						EYELET,METALLIC:0.152 OD X 0.245 INCH L,BRS	80009	210-0774-00	
-109	210-0775-00		10						EYELET,METALLIC:0.126 OD X 0.23 INCH L,BRS	80009	210-0775-00	

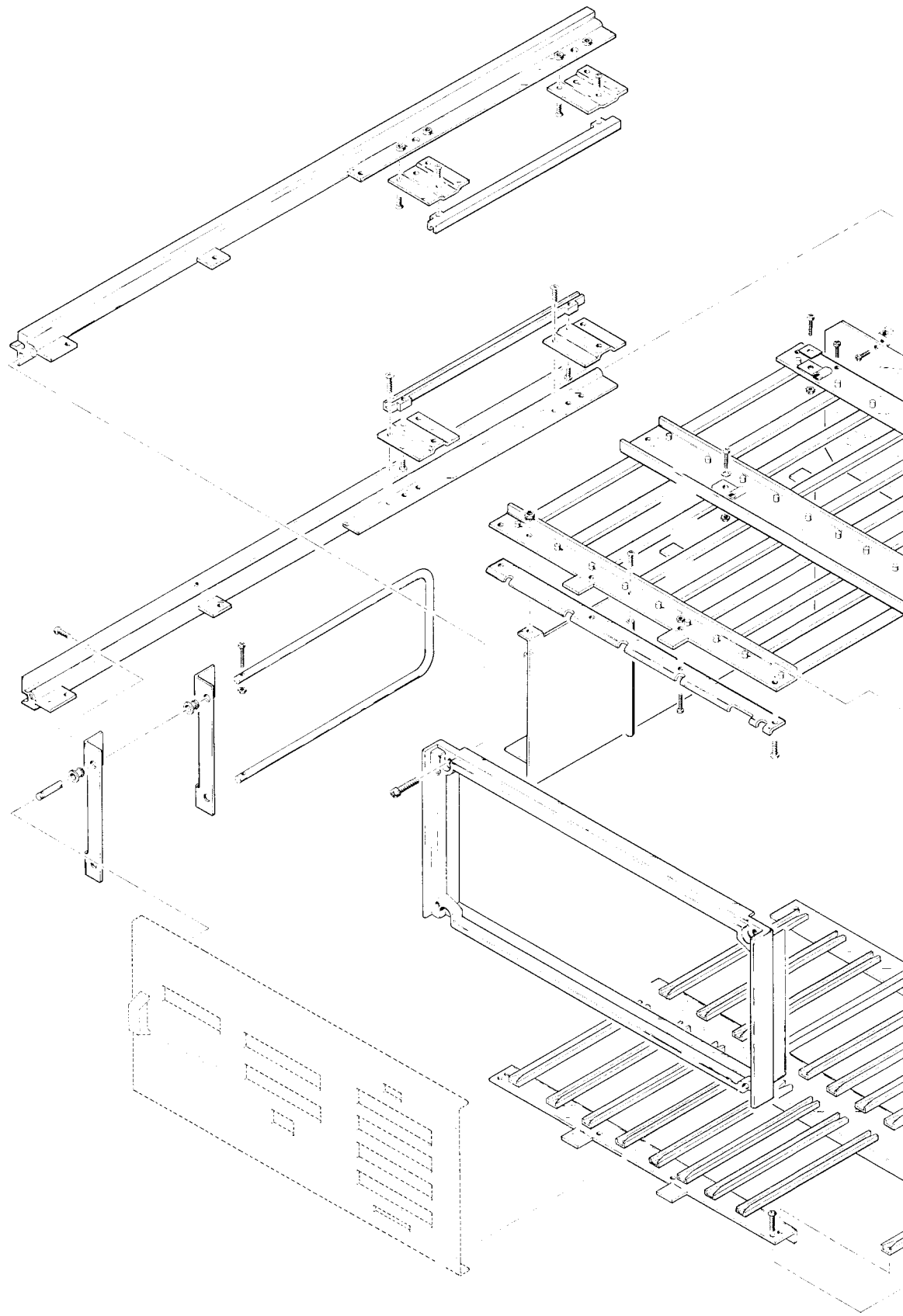
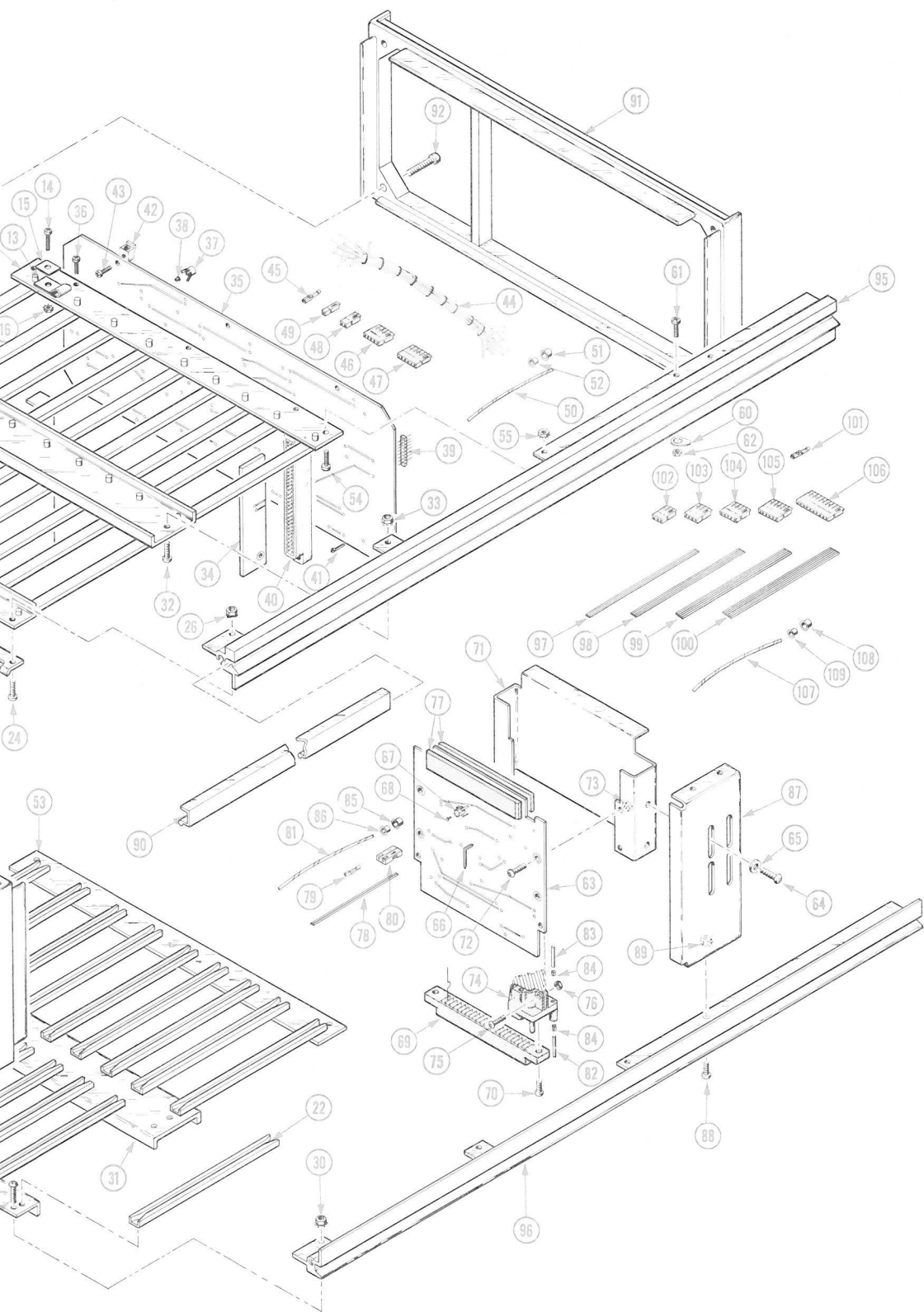



FIG. 1 EXPLODED



P7001 MAINFRAME